

A Better Conduit Outlet Body — Inside and Out!

T&B® Fittings

BlueKote™ Form 7 and Form 8 Conduit Outlet Bodies

*BlueKote™ internal
surface coating reduces
force required to pull wires*

*Cover with integral gasket
reduces inventory and chance of
misplacing a separate gasket!*

*Triple-layer protection — including
two layers of epoxy coating — stops
corrosion in its tracks!*



BlueKote™ Form 7 and Form 8 Conduit Outlet Bodies



Faster, Easier Wire Pulling and Extra Corrosion Resistance!

Why take a chance of damaging your wires while pulling them through conduit bodies? Thomas & Betts has enhanced its line of Form 7 and Form 8 conduit outlet bodies to outperform the competition in these areas and more. T&B BlueKote™ Form 7 and Form 8 conduit outlet bodies feature a slick, Teflon® based BlueKote™ interior finish to make wire pulling faster and easier than ever before and eliminate rough internal surfaces that can damage wires. To safeguard against corrosion, these conduit outlet bodies incorporate not one, not two, but three layers of protection — including two layers of epoxy coating. And to reduce inventory and provide up-front cost savings, both steel and iron covers now come standard with an integral neoprene gasket.



Four-layer protection for the ultimate in corrosion resistance!



Bare Conduit Body

Left in its raw state, all cast iron conduit bodies will rapidly corrode. Anytime the outer finish is compromised, corrosion will attack and propagate throughout the fitting.



Layer 1 — Electro Zinc Plating with Dichromate finish. This layer acts as a durable corrosion inhibitor. It protects the cast iron alloy conduit body from rust, and unlike painted coatings, prevents rust creep. This layer is an industry standard for corrosion resistance.



Layer 2 — Baked-On Epoxy Powder Coating. Epoxy is one of the most corrosion-resistant finishes available. This layer is powder coated, because unlike a conventionally painted surface, a powder-coated finish eliminates pinholes, cracks and crevices, is scratch resistant and holds up better against harsh chemicals.



Layer 3 — Baked-On Epoxy Paint. A final layer of epoxy paint provides the conduit outlet body with even more corrosion resistance.



Baked-On BlueKote™ Teflon® based coating inside the conduit outlet body provides a slick surface for easier wire pulling. It also provides more corrosion resistance on the inside of the conduit body by adding an additional layer of protection.



Form 7 and Form 8 Covers

BlueKote™ Teflon®-based internal finish

- Provides a slick, easy-glide internal surface
- Significantly lowers the amount of force necessary to pull wires
- Reduces installation time and risk of installer strain
- Eliminates rough internal surfaces that can cut into cable jacket, insulation and conductors during pulling

The Result

T&B BlueKote™ conduit outlet body and a leading competitor's conduit outlet body after a seven-day 5% salt-fog chamber test.

The T&B BlueKote™ conduit outlet body still has a glossy sheen and no evidence of salt adhesion or penetration.

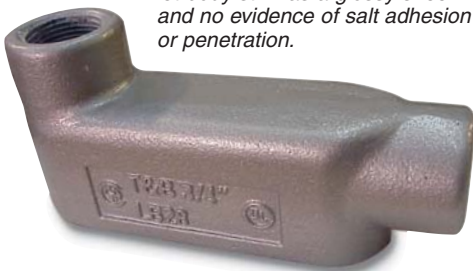

The competitor's conduit outlet body has severe salt adhesion and significant rusting.



Cat. Number	Hub Size	Std. Pkg. Qty.	UPC Number
Form 7 Stamped Steel Cover with Integral Gasket			
170S	1/2"	25	786210-98581
270S	3/4"	25	786210-98585
370S	1"	20	786210-98590
470S	1 1/4"	10	786210-98021
570S	1 1/2"	10	786210-98591
670S	2"	10	786210-98592
870S	2 1/2"-3"	5	786210-98594
970S	3 1/2"-4"	5	786210-98598
Form 8 Stamped Steel Cover with Integral Gasket			
180	1/2"	25	786210-16494
280	3/4"	25	786210-16495
380	1"	25	786210-16498
480	1 1/4"	10	786210-16500
580	1 1/2"	10	786210-16504
680	2"	10	786210-16506
680STB	2 1/2"-3"	5	786210-16515
980	3 1/2"-4"	5	786210-16516
Form 7 Iron Cover with Integral Gasket			
170F	1/2"	20	786210-92379
270F	3/4"	20	786210-92381
370F	1"	50	786210-92412
470F	1 1/4"	5	786210-98020
570F	1 1/2"	5	786210-92413
670F	2"	5	786210-92420
870F	2 1/2"-3"	5	786210-92432
970F	3 1/2"-4"	5	786210-98598
Form 8 Iron Cover with Integral Gasket			
180F	1/2"	20	786210-16486
280F	3/4"	10	786210-16487
380F	1"	10	786210-16488
480F	1 1/4"	5	786210-16489
580F	1 1/2"	5	786210-16490
680F	2"	5	786210-16491
880F	2 1/2"-3"	5	786210-16492
980F	3 1/2"-4"	5	786210-16493
Form 7 Replacement Gasket			
GASK 571	1/2"	50	786210-93298
GASK 572	3/4"	50	786210-93299
GASK 573	1"	50	786210-93300
GASK 574	1 1/4"	5	786210-98023
GASK 575	1 1/2"	5	786210-93301
GASK 576	2"	5	786210-93303
GASK 578	2 1/2"-3"	5	786210-93307
GASK 579	3 1/2"-4"	5	786210-14738
Form 8 Replacement Gasket			
GASK 581N	1/2"	20	786210-16527
GASK 582N	3/4"	20	786210-16518
GASK 583N	1"	10	786210-16521
GASK 584N	1 1/4"	5	786210-16522
GASK 585N	1 1/2"	5	786210-16524
GASK 586N	2"	5	786210-16526
GASK 588N	2 1/2"-3"	5	786210-16529
GASK 589N	3 1/2"-4"	5	786210-16530





BlueKote™ Form 7 and Form 8 Conduit Outlet Bodies

Cat. Number	Size	Dimensions (in.)						Std. Pkg. Qty.	UPC Number
		A	B	C	D	E	CI		
LB Form 7 BlueKote™									
LB17	½	4.60	2.20	1.35	.95	3.20	4.0	25	786210-92460
LB27	¾	5.25	2.40	1.65	1.15	3.80	6.6	20	786210-92461
LB37	1	6.00	2.65	1.80	1.35	4.55	10.6	10	786210-92462
LB47	1¼	6.45	3.20	2.20	1.80	5.00	18.8	20	786210-93337
LB57	1½	7.25	3.90	2.45	2.05	5.45	26.4	10	786210-93338
LB67	2	8.30	4.45	3.10	2.45	6.40	51.0	1	786210-93339
LB77	2½	10.55	5.20	4.25	3.60	8.40	102.0	1	786210-93340
LB87	3	10.55	5.95	4.25	3.60	8.40	132.0	1	786210-93341
LB97	3½	12.85	6.70	5.25	4.55	10.25	210.0	1	786210-93342
LB107	4	12.85	7.20	5.25	4.55	10.25	243.0	1	786210-93343
LB Form 8 BlueKote™									
LB18	½	4 ¹ / ₁₆	2.219	1 ¹ / ₁₆	1	3 ³ / ₁₆	4.9	25	786210-16560
LB28	¾	5 ⁵ / ₁₆	2.438	1 ¹ / ₁₆	1 ¹ / ₁₆	3 ³ / ₁₆	8.0	20	786210-16565
LB38	1	6 ¹ / ₁₆	2.813	1 ¹ / ₁₆	1 ¹ / ₁₆	4 ¹ / ₁₆	13.0	4	786210-16566
LB448	1¼	7 ¹⁷ / ₃₂	3 ¹¹ / ₃₂	2 ³ / ₁₆	1 ¹ / ₁₆	5 ⁵ / ₁₆	23.5	10	786210-16567
LB58	1½	9 ¹ / ₁₆	4 ¹ / ₁₆	2 ¹ / ₁₆	2 ¹ / ₁₆	6 ¹ / ₁₆	45.0	2	786210-16568
LB68	2	11	4 ¹³ / ₃₂	3 ³ / ₄	3	8 ⁵ / ₁₆	88.0	1	786210-16569
LB78	2½	13 ¹ / ₁₆	6 ¹ / ₁₆	5	4 ¹ / ₁₆	10 ¹ / ₁₆	110.0	1	786210-16570
LB888	3	13 ¹ / ₁₆	6 ¹ / ₁₆	5	4 ¹ / ₁₆	10 ¹ / ₁₆	110.0	1	786210-16571
LB98	3½	16 ¹ / ₁₆	7 ¹ / ₁₆	6 ¹ / ₁₆	5 ¹ / ₁₆	1 ³ / ₁₆	250.0	1	786210-16572
LB108	4	16 ¹ / ₁₆	7 ¹ / ₁₆	6 ¹ / ₁₆	5 ¹ / ₁₆	1 ³ / ₁₆	250.0	?	786210-16573
T Form 7 BlueKote™									
T17	½	5.60	1.80	2.35	.95	3.20	6.0	20	786210-92497
T27	¾	6.20	2.00	2.60	1.15	3.80	9.1	10	786210-92498
T37	1	7.35	2.30	3.10	1.35	4.55	16.9	10	786210-92499
T47	1¼	7.30	2.30	3.05	1.80	5.00	19.3	20	786210-93442
T57	1½	8.60	2.60	3.80	2.05	5.45	27.5	10	786210-93443
T67	2	9.50	3.20	4.25	2.45	6.40	50.0	10	786210-93444
T77	2½	12.10	3.65	5.80	3.60	8.40	102.0	1	786210-93445
T87	3	12.10	4.40	5.80	3.60	8.40	132.0	1	786210-93446
T97	3½	14.65	4.90	7.05	4.55	10.25	210.0	1	786210-93447
T107	4	14.65	5.40	7.05	4.55	10.25	243.0	1	786210-93448
T Form 8 BlueKote™									
T18	½	5 ¹ / ₁₆	1 ¹ / ₁₆	2 ⁵ / ₃₂	1	3 ³ / ₁₆	6.0	20	786210-16609
T28	¾	6 ³ / ₃₂	2	2 ⁵ / ₁₆	1 ¹ / ₁₆	3 ³ / ₁₆	9.0	10	786210-16610
T38-TB	1	7 ¹ / ₁₆	2 ¹ / ₁₆	2 ¹ / ₁₆	1 ¹ / ₁₆	4 ¹ / ₁₆	15.0	10	786210-16612
T448	1¼	8 ¹ / ₁₆	2 ³ / ₁₆	3 ⁵ / ₃₂	1 ¹ / ₁₆	5 ⁵ / ₁₆	24.0	2	786210-16615
T58	1½	10 ³ / ₁₆	2 ²⁵ / ₃₂	4	2 ¹ / ₁₆	6 ¹ / ₁₆	46.5	2	786210-16617
T68	2	12 ¹ / ₄	3 ³ / ₁₆	5	3	8 ⁵ / ₁₆	88.0	2	786210-16618
T78	2½	15 ¹ / ₁₆	4 ¹ / ₁₆	6 ¹ / ₁₆	4 ¹ / ₁₆	10 ¹ / ₁₆	110.0	1	786210-16624
T88-TB	3	15 ¹ / ₁₆	4 ¹ / ₁₆	6 ¹ / ₁₆	4 ¹ / ₁₆	10 ¹ / ₁₆	110.0	1	786210-16625
C Form 8 BlueKote™									
C18	½	5 ¹⁷ / ₃₂	1 ¹ / ₁₆	1 ¹ / ₁₆	1	3 ³ / ₁₆	4.9	25	786210-16532
C28	¾	6 ³ / ₃₂	1 ¹⁷ / ₃₂	1 ¹ / ₁₆	1 ¹ / ₁₆	3 ³ / ₁₆	8.0	25	786210-16534
C38	1	7 ¹ / ₁₆	1 ¹⁵ / ₁₆	1 ¹ / ₁₆	1 ¹ / ₁₆	4 ¹ / ₁₆	13.0	20	786210-16536
C448	1¼	8 ¹ / ₁₆	2 ³ / ₁₆	2 ³ / ₁₆	1 ¹ / ₁₆	5 ⁵ / ₁₆	23.5	2	786210-16538
C58-TB	1½	10 ¹ / ₁₆	2 ²⁵ / ₃₂	2 ¹ / ₁₆	2 ¹ / ₁₆	6 ¹ / ₁₆	45.0	10	786210-16539
C68	2	12 ¹ / ₄	3 ³ / ₁₆	3 ³ / ₁₆	3	8 ⁵ / ₁₆	88.0	2	786210-16549
C78	2½	15 ¹ / ₁₆	4 ¹ / ₁₆	5	4 ¹ / ₁₆	10 ¹ / ₁₆	110.0	1	786210-16552
C88	3	15 ¹ / ₁₆	4 ¹ / ₁₆	5	4 ¹ / ₁₆	10 ¹ / ₁₆	110.0	1	786210-16556
LL Form 7 BlueKote™									
LL17	½	4.60	1.40	1.45	.95	3.20	4.0	25	786210-92487
LL27	¾	5.25	1.60	1.65	1.15	3.80	6.6	20	786210-92492
LL37	1	6.00	1.90	2.60	1.35	4.55	10.6	25	786210-92493
LL47	1¼	6.45	2.30	3.05	1.80	5.00	18.6	20	786210-93344
LL57	1½	7.90	2.60	3.80	2.05	5.45	26.4	10	786210-93346
LL67	2	8.30	3.20	4.25	2.45	6.40	51.0	10	786210-93347
LL77	2½	10.55	3.65	5.80	3.60	8.40	102.0	1	786210-93348
LL87	3	10.55	4.40	5.80	3.60	8.40	132.0	1	786210-93349
LL97	3½	12.85	4.90	7.03	4.55	10.25	210.0	1	786210-93350
LL107	4	12.85	5.40	7.03	4.55	10.25	243.0	1	786210-93351
LL Form 8 BlueKote™									
LL18	½	4 ¹ / ₁₆	1 ¹ / ₁₆	2 ⁵ / ₃₂	1	3 ³ / ₁₆	4.9	25	786210-16577
LL28	¾	5 ⁵ / ₁₆	1 ¹ / ₁₆	2 ⁵ / ₁₆	1 ¹ / ₁₆	3 ³ / ₁₆	8.0	20	786210-16578
LL38	1	6 ¹ / ₁₆	1 ¹⁵ / ₁₆	2 ¹ / ₁₆	1 ¹ / ₁₆	4 ¹ / ₁₆	13.0	25	786210-16579
LL448	1¼	7 ¹⁷ / ₃₂	2 ³ / ₁₆	3 ⁵ / ₃₂	1 ¹ / ₁₆	5 ⁵ / ₁₆	23.5	20	786210-16580
LL58	1½	9 ¹ / ₁₆	2 ²⁵ / ₃₂	4	2 ¹ / ₁₆	6 ¹ / ₁₆	45.0	10	786210-16581
LL68	2	11	3 ³ / ₁₆	5	3	8 ⁵ / ₁₆	88.0	5	786210-16582
LL78	2½	13 ¹ / ₁₆	4 ¹ / ₁₆	6 ¹ / ₁₆	4 ¹ / ₁₆	10 ¹ / ₁₆	110.0	1	786210-16594
LL888	3	13 ¹ / ₁₆	4 ¹ / ₁₆	6 ¹ / ₁₆	4 ¹ / ₁₆	10 ¹ / ₁₆	110.0	1	786210-16595

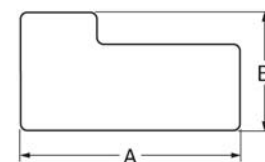
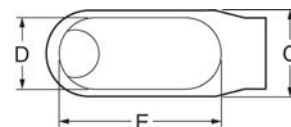

LB Form 7 and Form 8

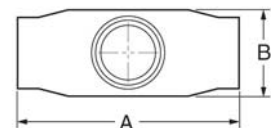
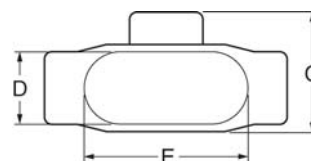

T Form 7 and Form 8

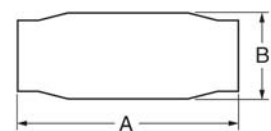
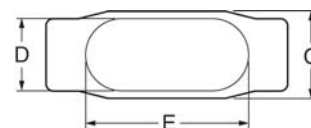

C Form 7 and Form 8

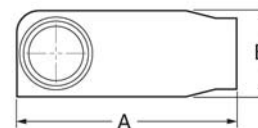
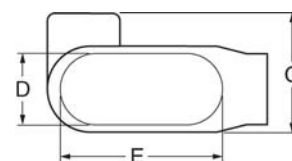

LL Form 7 and Form 8



BlueKote™ Form 7 and Form 8 Conduit Outlet Bodies (continued)

Cat. Number	Size	Dimensions (in.)					Cl	Std. Pkg. Qty.	UPC Number
		A	B	C	D	E			
LR Form 7 BlueKote™									
LR17	½	4.60	1.40	1.45	.95	3.20	4.0	25	786210-92494
LR27	¾	5.25	1.60	1.65	1.15	3.80	6.6	20	786210-92495
LR37	1	6.00	1.90	2.60	1.35	4.55	10.6	25	786210-92496
LR47	1¼	6.45	2.30	3.05	1.80	5.00	18.8	20	786210-93352
LR57	1½	7.90	2.60	3.80	2.05	5.45	26.4	20	786210-93354
LR67	2	8.30	3.20	4.25	2.45	6.40	51.0	10	786210-93436
LR77	2½	10.55	3.65	5.80	3.60	8.40	102.0	1	786210-93438
LR87	3	10.55	4.40	5.80	3.60	8.40	132.0	1	786210-93439
LR97	3½	12.85	4.90	7.03	4.55	10.25	210.0	1	786210-93440
LR107	4	12.85	5.40	7.03	4.55	10.25	243.0	1	786210-93441
LR Form 8 BlueKote™									
LR18	½	4½ ₁₆	1½ ₁₆	2½ ₃₂	1	3½ ₁₆	4.4	25	786210-16596
LR28	¾	5½ ₁₆	1½ ₁₆	2½ ₁₆	1½ ₁₆	3½ ₁₆	8.0	25	786210-16597
LR38	1	6½ ₃₂	1½ ₁₆	2½	1½	4½ ₁₆	13.0	25	786210-16599
LR448	1¼	7½ ₃₂	2½	3½ ₃₂	1½	5½ ₁₆	23.6	20	786210-16600
LR58	1½	9½	2½ ₃₂	4	2½	6½	45.0	10	786210-16601
LR68	2	11	3½ ₁₆	5	3	8½ ₁₆	88.0	10	786210-16606
LR78	2½	13½ ₁₆	4½ ₁₆	6½ ₁₆	4½	10½	110.0	1	786210-16607
LR888	3	13½ ₁₆	4½ ₁₆	6½ ₁₆	4½	10½	110.0	5	786210-16608
L Form 7 BlueKote™									
L17-TB	½	4.60	1.40	1.45	.95	3.20	—	5	786210-08666
L27-TB	¾	5.25	1.60	1.65	1.15	3.80	—	5	786210-08667
L37-TB	1	6.00	1.90	2.60	1.35	4.55	—	5	786210-08668
L47-TB	1¼	6.45	2.30	3.05	1.80	5.00	—	5	786210-08669
L57-TB	1½	7.90	2.60	3.80	2.05	5.45	—	5	786210-08677
L67-TB	2	8.30	3.20	4.25	2.45	6.40	—	5	786210-08678
TB Form 8 BlueKote™									
TB18	½	5½ ₁₆	2½	1½	1	3½ ₁₆	6.0	5	786210-16626
TB28	¾	6½ ₃₂	2½	1½ ₁₆	1½ ₁₆	3½ ₁₆	9.0	5	786210-16627
TB38	1	7½ ₁₆	3½	1½	1½	4½ ₁₆	15.0	5	786210-19946
TB448	1¼	8½	3½ ₁₆	2½ ₁₆	1½	5½ ₁₆	24.0	2	786210-16629
TB58	1½	10½	3½ ₁₆	2½	2½	6½	46.5	2	786210-16631
TB68	2	12¼	4½	3½	3	8½ ₁₆	88.0	2	786210-16633
X Form 7 BlueKote™									
X17	½	5.60	1.80	3.05	.95	3.20	6.0	10	786210-08460
X27	¾	6.20	2.00	3.30	1.15	3.80	9.1	10	786210-08470
X37	1	7.35	2.30	3.80	1.35	4.55	16.9	5	786210-08472
X47	1¼	7.30	2.30	3.85	1.80	5.00	19.3	5	786210-08663
X57	1½	8.60	2.60	5.05	2.05	5.45	27.5	5	786210-08664
X67	2	9.50	3.20	5.45	2.45	6.40	52.8	5	786210-08665
X Form 8 BlueKote™									
X18	½	5½ ₁₆	1½	2½ ₃₂	1	3½ ₁₆	6.0	5	786210-16634
X28	¾	6½ ₃₂	2	3½ ₁₆	1½	3½ ₁₆	9.0	5	786210-16635
X38	1	7½ ₁₆	2½	3½	1½	4½ ₁₆	15.0	5	786210-16636
X448	1¼	8½	2½	4½	1½	5½ ₁₆	24.0	2	786210-16638
X58	1½	10½	2½ ₃₂	5½	2½	6½	46.5	2	786210-16639
X68	2	12¼	3½ ₁₆	6¼	3	8½ ₁₆	88.0	2	786210-16641
E Form 7 BlueKote™									
E17	½	4.60	1.40	1.45	.95	3.20	6.0	5	786210-08679
E27	¾	5.25	1.60	1.65	1.15	3.80	9.1	5	786210-08680
E37	1	6.00	1.90	1.80	1.35	4.55	16.9	5	786210-08681

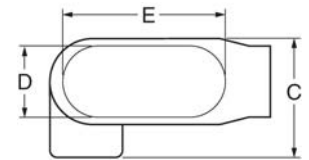

LR Form 7 and Form 8

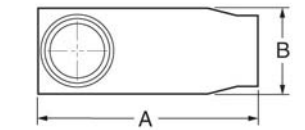
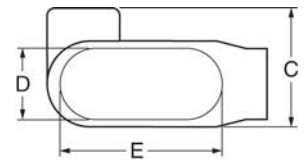

L Form 7

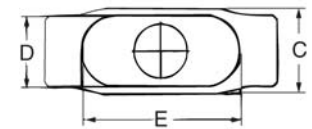
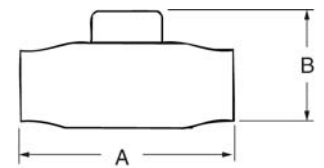

TB Form 8

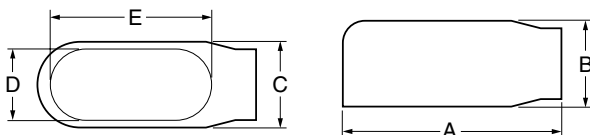

E Form 7

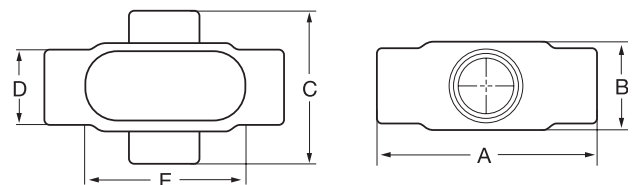

X Form 7 and Form 8



Order T&B BlueKote™ Form 7 Conduit Outlet Bodies Pre-Assembled with Covers and Gaskets!

For your convenience and inventory reduction, T&B BlueKote™ Form 7 Conduit Outlet Bodies can be purchased pre-assembled with body, stamped steel cover and integral gasket all included. To order, simply add CG-TB to the catalog number for any Form 7 Conduit Outlet Body. For example, Catalog No. LB27CG-TB is an LB27 ¾" LB-style BlueKote™ Form 7 conduit outlet body pre-assembled with 270S stamped steel cover with integral neoprene gasket.



T&B® Pre-Assembled Bodies, Gaskets and Covers

Cat. Number	Trade Size	Pre-Assembled Products	Std. Pkg. Qty.	UPC Number
C17CG-TB	½"	C17 Body, Cover & Gasket	10	786210-91679
C27CG-TB	¾"	C27 Body, Cover & Gasket	5	786210-91680
C37CG-TB	1"	C37 Body, Cover & Gasket	5	786210-91681
C47CG-TB	1½"	C47 Body, Cover & Gasket	2	786210-91682
C57CG-TB	1½"	C57 Body, Cover & Gasket	2	786210-91683
C67CG-TB	2"	C67 Body, Cover & Gasket	2	786210-91684
LB17CG-TB	½"	LB17 Body, Cover & Gasket	5	786210-91667
LB27CG-TB	¾"	LB27 Body, Cover & Gasket	5	786210-91668
LB37CG-TB	1"	LB37 Body, Cover & Gasket	5	786210-91669
LB47CG-TB	1½"	LB47 Body, Cover & Gasket	2	786210-91670
LB57CG-TB	1½"	LB57 Body, Cover & Gasket	5	786210-91671
LB67CG-TB	2"	LB67 Body, Cover & Gasket	2	786210-91672
LL17CG-TB	½"	LL17 Body, Cover & Gasket	5	786210-91685
LL27CG-TB	¾"	LL27 Body, Cover & Gasket	5	786210-91686
LL37CG-TB	1"	LL37 Body, Cover & Gasket	5	786210-91687
LL47CG-TB	1½"	LL47 Body, Cover & Gasket	2	786210-91688
LL57CG-TB	1½"	LL57 Body, Cover & Gasket	2	786210-91689
LL67CG-TB	2"	LL67 Body, Cover & Gasket	2	786210-91690
LR17CG-TB	½"	LR17 Body, Cover & Gasket	5	786210-91691
LR27CG-TB	¾"	LR27 Body, Cover & Gasket	5	786210-91693
LR37CG-TB	1"	LR37 Body, Cover & Gasket	5	786210-91694
LR47CG-TB	1½"	LR47 Body, Cover & Gasket	2	786210-91695
LR57CG-TB	1½"	LR57 Body, Cover & Gasket	2	786210-91696
LR67CG-TB	2"	LR67 Body, Cover & Gasket	2	786210-91697
T17CG-TB	½"	T17 Body, Cover & Gasket	5	786210-91673
T27CG-TB	¾"	T27 Body, Cover & Gasket	5	786210-91674
T37CG-TB	1"	T37 Body, Cover & Gasket	2	786210-91675
T47CG-TB	1½"	T47 Body, Cover & Gasket	2	786210-91676
T57CG-TB	1½"	T57 Body, Cover & Gasket	2	786210-91677
T67CG-TB	2"	T67 Body, Cover & Gasket	2	786210-91678
TB17CG-TB	½"	TB17 Body, Cover & Gasket	5	786210-91698
TB27CG-TB	¾"	TB27 Body, Cover & Gasket	5	786210-91699
TB37CG-TB	1"	TB37 Body, Cover & Gasket	2	786210-91700
TB47CG-TB	1½"	TB47 Body, Cover & Gasket	2	786210-91701
TB57CG-TB	1½"	TB57 Body, Cover & Gasket	2	786210-91702
TB67CG-TB	2"	TB67 Body, Cover & Gasket	2	786210-91703
X17CG-TB	½"	X17 Body, Cover & Gasket	5	786210-91704
X27CG-TB	¾"	X27 Body, Cover & Gasket	2	786210-91705
X37CG-TB	1"	X37 Body, Cover & Gasket	1	786210-91706
X47CG-TB	1½"	X47 Body, Cover & Gasket	2	786210-91707
X57CG-TB	1½"	X57 Body, Cover & Gasket	1	786210-91708
X67CG-TB	2"	X67 Body, Cover & Gasket	1	786210-91710

Sample Specifications for Conduit Outlet Bodies:

1. For protection against corrosion, conduit bodies are to have an electro galvanized finish, followed by a baked-on powder epoxy finish to a minimum of 2.5 mil thickness, and at least one additional baked layer of epoxy applied with an additional 2.0 mil thickness or better.
2. To aid in wire pull, and reduce wire damage, the interior of the conduit bodies are to include a baked-on Teflon® based coating of 2.0 mils minimum thickness.

www.tnb.com

Thomas & Betts

Please ask your Thomas & Betts sales representative for a complete catalog of quality Thomas & Betts electrical products or visit us at www.tnb.com. For customer service, call 1-800-816-7809. For technical questions, call 1-888-862-3289.

Thomas & Betts Corporation
Electrical Division
8155 T&B Boulevard
Memphis, TN 38125
901-252-5000

Thomas & Betts Ltd.
700 Thomas Avenue
Iberville, Québec J2X 2M9
450-347-5318